

## Description:

Appliance for installation in attenuation tanks. 3P Retention Regulator takes care of a regular drainage. The amount of regulation is adjustable (5 steps). Due to the flexible arm and brushes which are mounted on the retention we can guarantee that the opening of the regulator cannot be contaminated and is therefore low-maintenance.



## Technical Data:

Blue retention corpus: DN 110  
Material: Polyethylen

Material baffle and arm:  
Stainless steel of different composition

Material floating ball: Polyethylen

Material brushes: PVC and Polyethylen

Weight : 2,3 kg

Flow rate in litre per second

Baffle	A	B	C	D	E
Q l/sec	0,60	0,50	0,40	0,30	0,20

## How it works:

The baffle mounted on the regulator can be set in 5 different positions (see scale of technical data). In front of this baffle there is another baffle with a corrugated extract. This baffle is being moved through a floating ball depending on the water level. Due to this the corrugated opening narrows or dilates. Thus having a constant amount of water independent from the water level. A pair of brushes situated in front of the baffle is cleaning the corrugated opening with every move. Thus no aerosols can be accumulated at the opening.

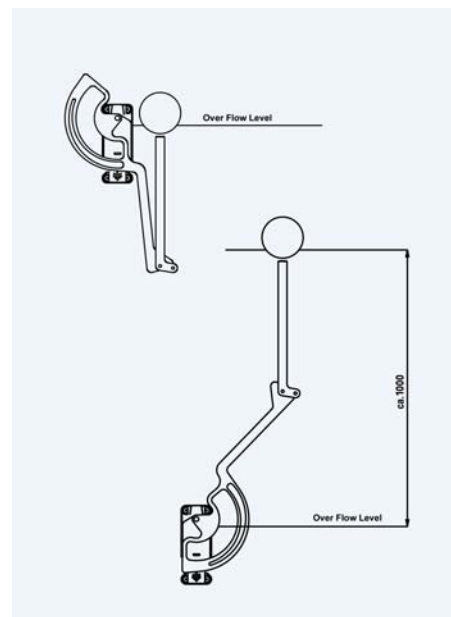

## Example of using:

Installation of the 3P Retention Regulator in a concrete tank. Very important is the 3P Attenuation and Infiltration Filter connected upstream to it. The volume of the retention results from the size of the property and the required amount which has to be regulated.

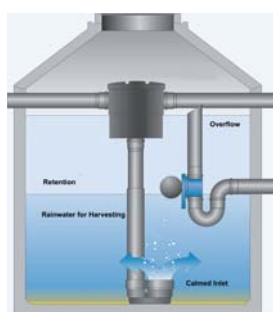

## Text for invitation of tenders:

Pos.	Quantity	Article	Price in €
1.1		3P Retention Regulator Housing and floating ball made of PE, self-cleaning mechanics made of stainless steel, adjustable baffle for constant drainage of 0,2 l/s to 0,6 l/s. Connection outlet DN 110, connection emergency overflow DN 110.	

## Packing unit:

Covering box: 790x575x700mm: 3 pieces  
Pallet: 18 pieces

## EAN:

## Observations:

The 3P Retention Regulator was tested by the Institute of Sanitary Engineering, Water Quality and Waste Control of the University of Stuttgart under the direction of Prof. Dr.-Ing. U. Rott.

## Description:

3P Flow Regulator for attenuation tanks.

The outlet port floats, as with a floating pump intake, so ensuring a constant head of water and so a constant discharge rate. The float position also ensures suspended materials from tank water surface do not enter any soakaway structure.



## Technical Data:

Floating ball Ø14 cm  
Material: Polyethylen

Hose: 1,5 m

Material connection parts: Brass

Material house clamps: Stainless steel

Weight: 1,3 kg

Flow rate in litre per second.

Q l/sec    0,05/ 0,1/ 0,15/ 0,27/  
              0,30/0,35/0,55/0,20

## How it works

Connection is installed in the height of the outflow. The flow regulator is situated between filter basket and brass spout. It consists of graded steps which are crosscutted according to the required quantity.

## Example:

3P Flow Regulator installed at the emergency overflow DN 110. 3P Attenuation and Infiltration Filter installed.

## Text for invitation of tenders:

Pos. Quantity Article

1.1 \_\_\_\_\_ 3P Flow Regulator  
With 1,5 m connector hose.

Price in €

\_\_\_\_\_



## Packing unit:

Covering box: 790x575x700mm: 12 pieces  
Pallet: 72 pieces

## EAN: